



Ocean Center
DAYTONA BEACH

Go Beyond...

ENTERTAINMENT TECH PACK

TABLE OF CONTENTS

Arena	1-4
Exhibit Hall	5
Ballroom	6
Dressing Rooms, Power and Electrical Services, Staging, House Inventory	7
Arena Loading Dock, Exhibit Hall Loading Dock	8
Deal Structure	9

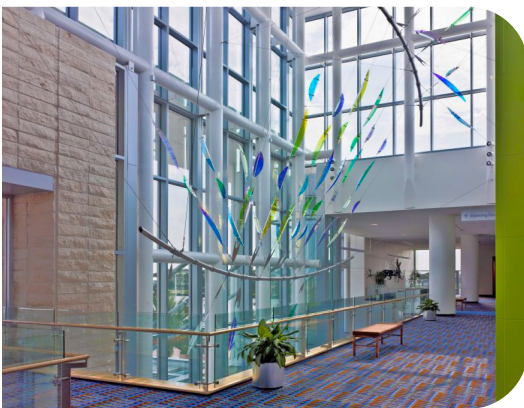

ARENA FLOORPLAN

The arena is a versatile and dynamic space designed to host a wide range of productions. It features flexible seating and stage configurations, ample rigging capabilities, high-quality sound and lighting systems with convenient loading dock access.

42,000 square feet

7,820 total seats

2,200 standing room

Stage Size: 60'W x 40'D x 4'H

Full House

Lower Seating: 2,696

Upper Seating: 3,336
(section 201 and 222 excluded)

Floor Seating: 1,788

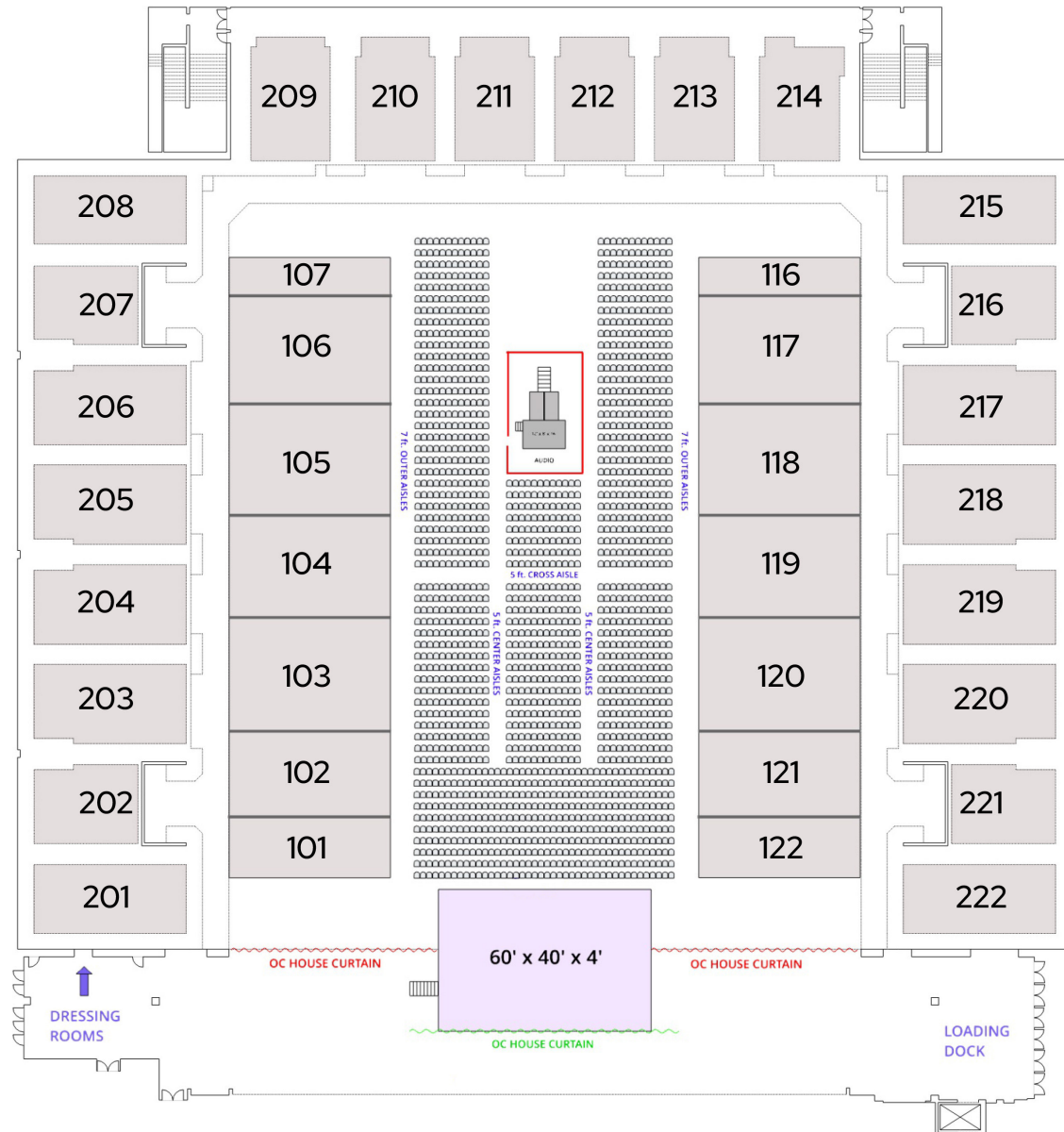

ARENA FLOORPLAN

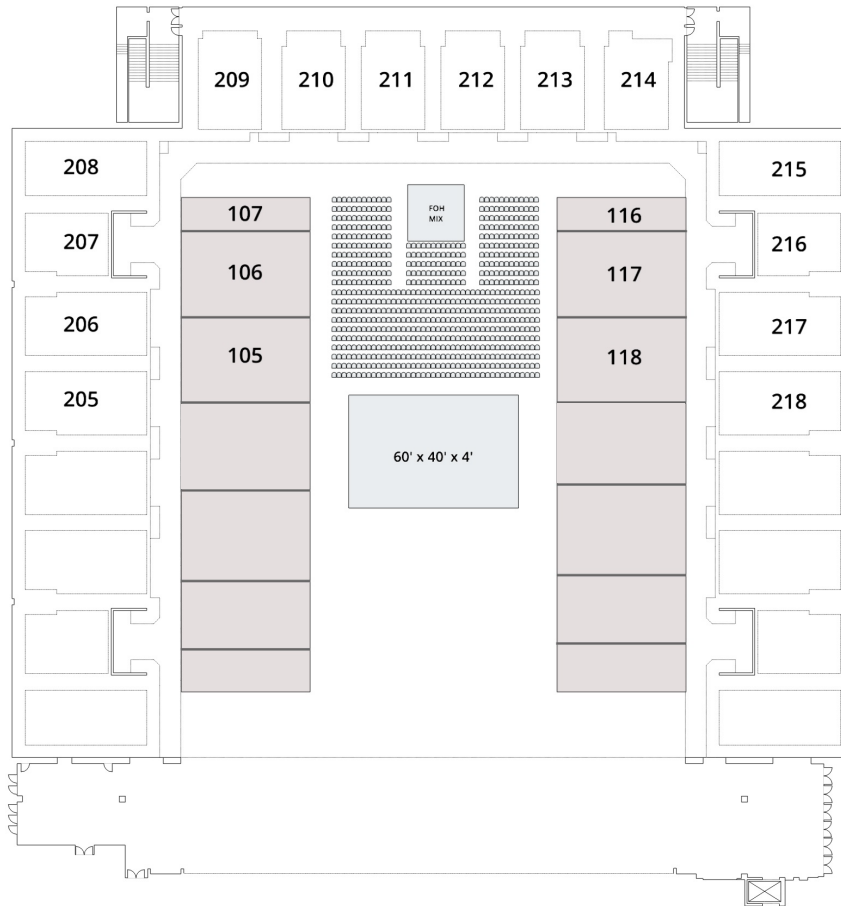

Half House

Lower Seating: 1,110

Upper Seating: 2,685

Floor: 720

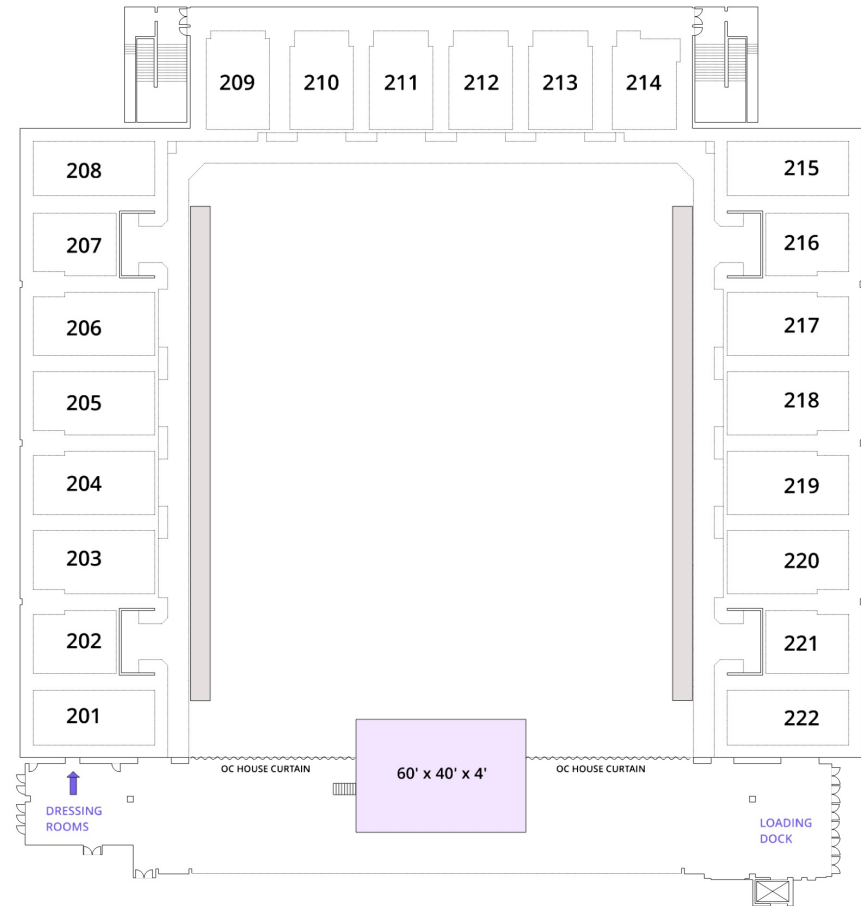

GA Standing

Lower Standing: 3,800

Upper Bowl: 3,891

Floor: 1,788 optional or 2,200 standing

ARENA RIGGING

Low steel height from finished floor is 47' | High steel height from finished floor is 72'

Rigging point weight ratings:

4,000 lb: 32 points distributed across the arena steel structure (low steel).

8,000 lb: 3 points centered on the east end of the arena directly above staging (low steel).

The facility coordinates use of riggers, load crew, stagehands, camera operators and spotlight operators in instances where the show promoter or lessee does not have their own. If the traveling production team does not include rigging personnel, the Ocean Center will exclusively manage all rigging services to ensure safety and efficiency.

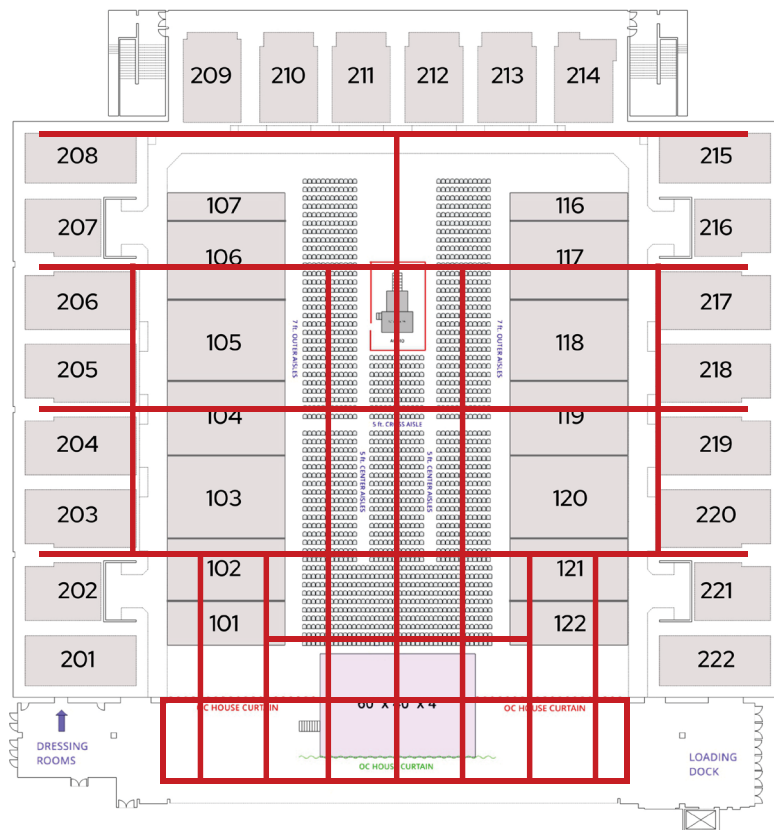

Chain Motors:

Description: ½ Ton Chain Motors

Quantity: 10 units available

Use: Suitable for lifting and rigging purposes

Truss Sections:

Rigging points

- 12"x12" Square Truss Sections:**

Quantity: 31 units available

Details: 10' sections including 4 corner pieces

- 12" Triangular Truss Sections:**

Quantity: 24 units available

Type: Rhone Tower

Details: Suitable for structural support and rigging

ARENA SYSTEMS

Sound

The in-house sounds system is optimized for voice clarity and is ideal for sports events, panels, and spoken word.

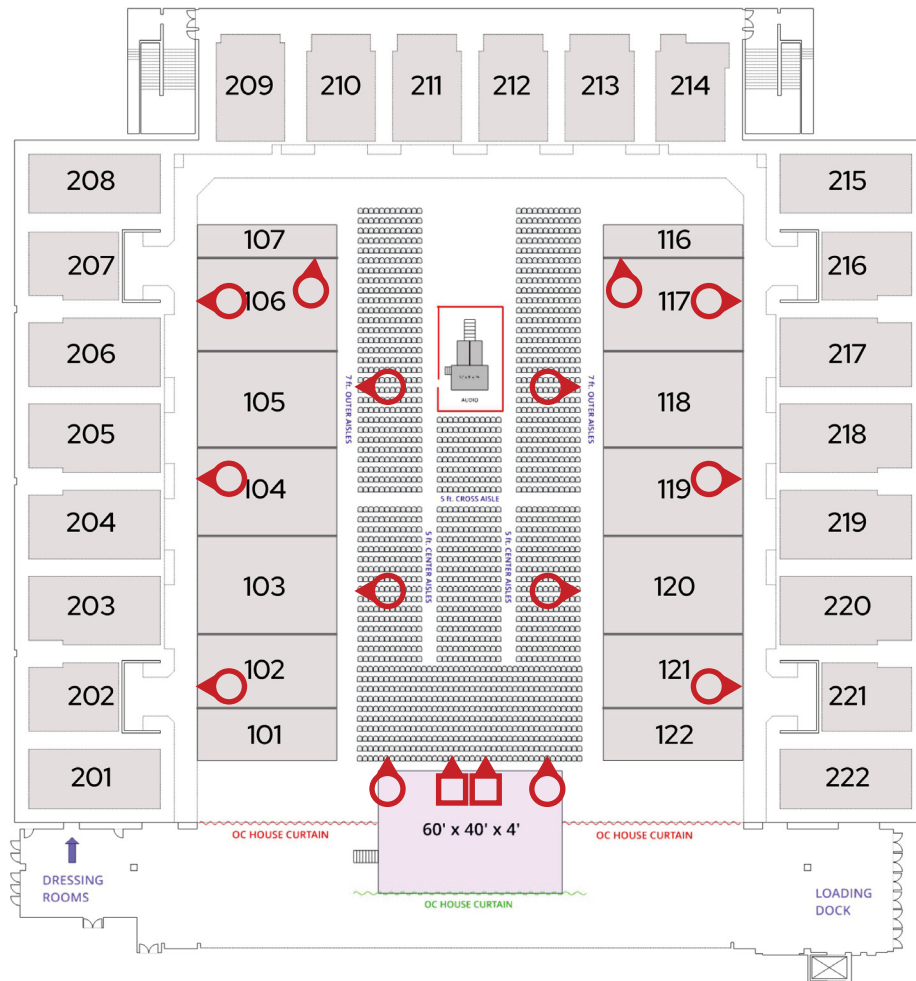

Lighting

House lighting is available and well suited for general event use such as ceremonies, speaking engagements, and conferences. See audio and lighting specifications for the Ocean Center.



EXHIBIT HALL FLOOR PLAN

Exhibit Hall

The Ocean Center's versatile Exhibit Hall offers over 93,000 square feet of adaptable space, designed to accommodate large-scale productions and custom event builds. Ideal for concerts, shows, festivals, and trade events, the hall supports a wide range of layouts and technical needs.

Ceiling Height: 32'

(with no rigging points)

Square feet: 93,000

Stage Size: 60'W x 40'D x 4'H

Standing Capacity: 9,000

Banquet Seating: 500

Theater Seating: 3,000

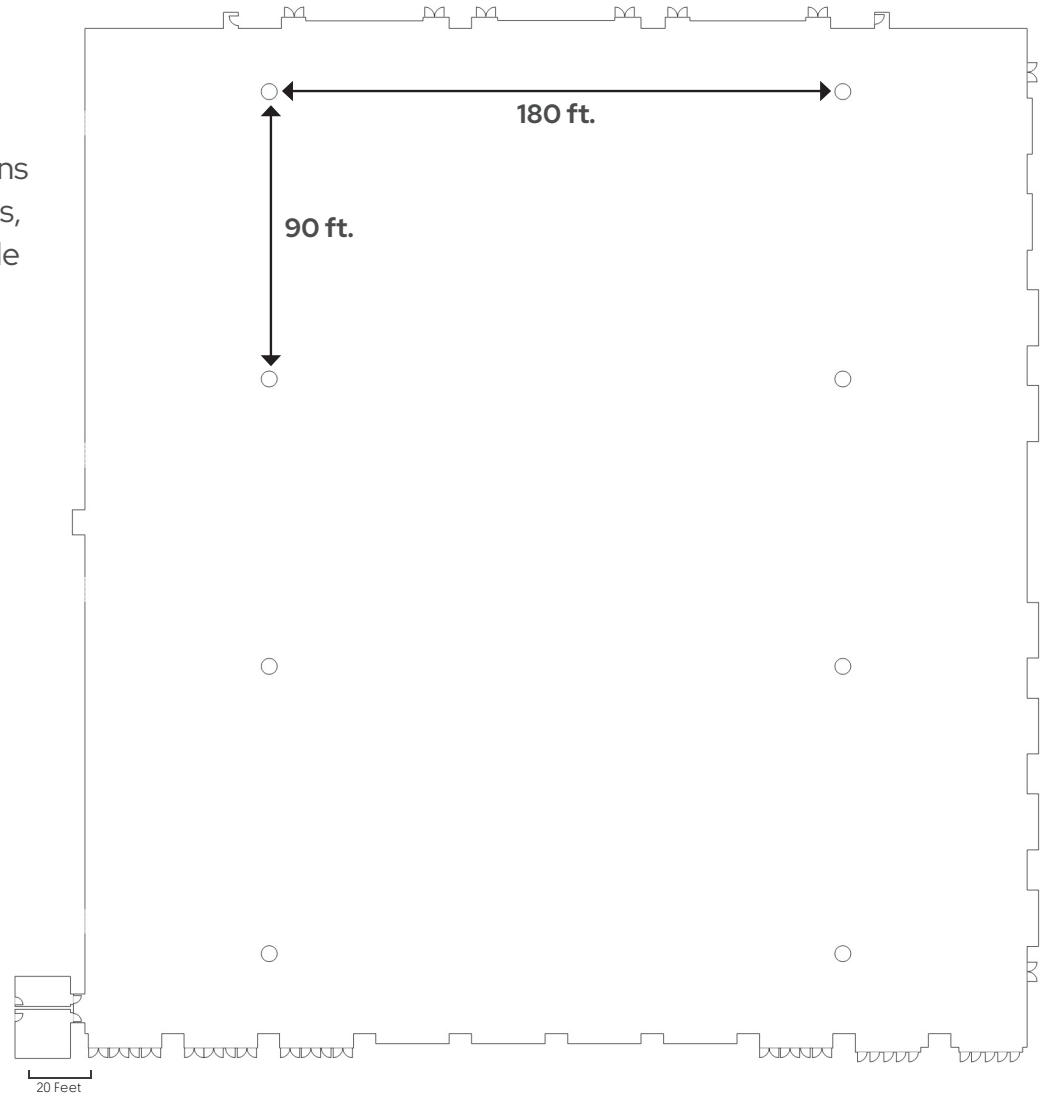

BALLROOM FLOOR PLAN

Ballroom

The ballroom offers an elegant and versatile setting for events and with over 12,000 square feet of customizable space, it's the ideal venue for intimate concerts.

Seated: 1,000 | Standing: 1,600

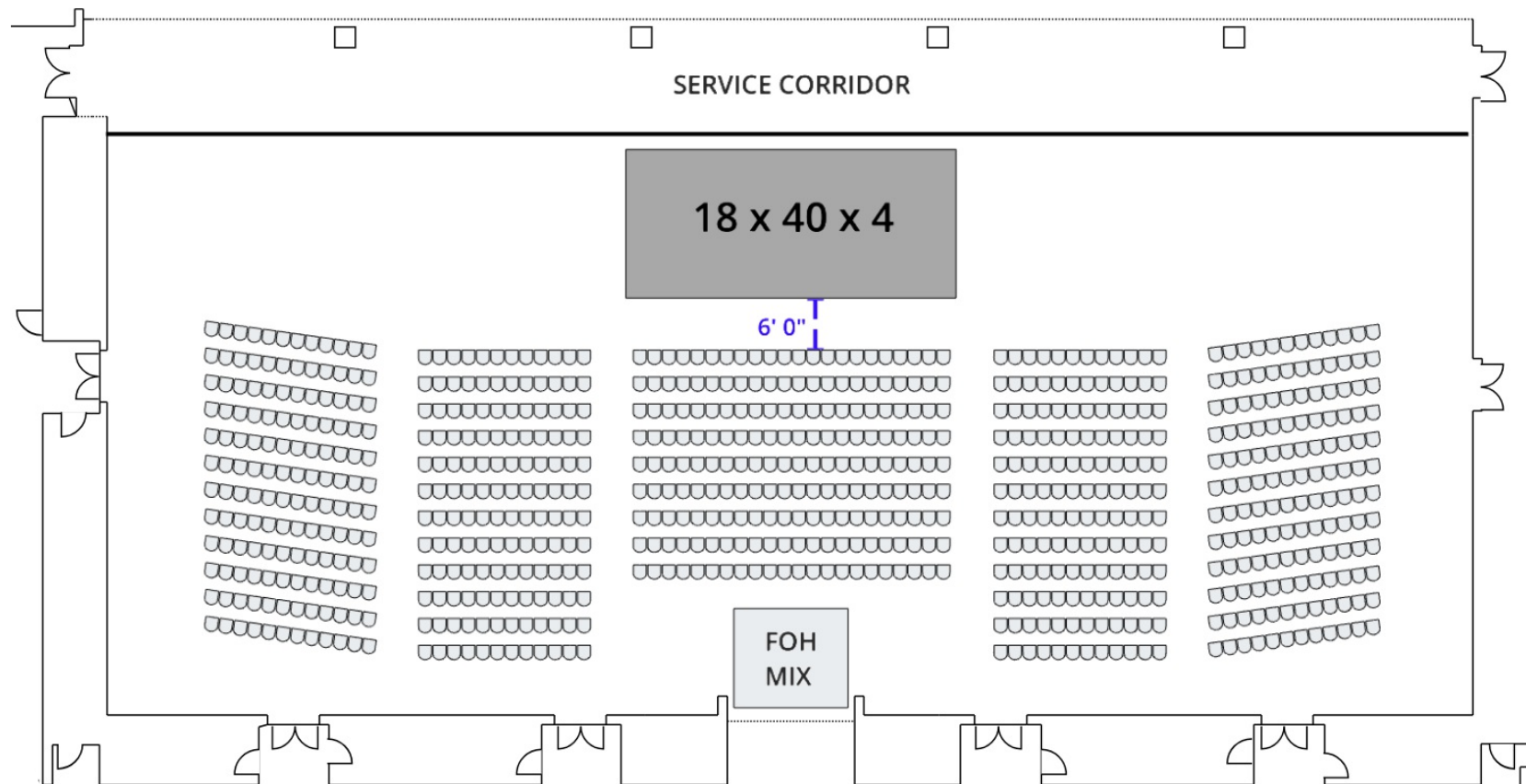

GENERAL INFORMATION

Dressing Rooms

Located approximately 100' offstage left, our eight dressing rooms offer private, comfortable spaces for talent prep.

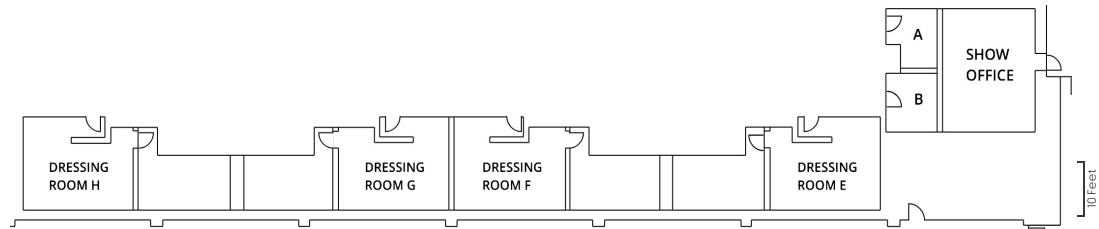

Dressing Rooms: 8

Dressing Rooms A & B: No Showers or Restrooms

Dressing Rooms C & D: 1 Shower, 1 Sink, 1 Stall

Dressing Rooms E-H: 4 Showers, 3 Sinks, 2 Stalls, 2 Urinals

Show Office

Power and Electrical Services

Stage power is included in rent. Additional power is available from floor boxes strategically located in the arena, exhibit hall and ballroom. Power is provided exclusively in-house.

Available Staging

80'W x 40'D x 4'H

60'W x 40'D x 2'H

House Inventory

A list of production related inventory available upon request.



GENERAL INFORMATION

Arena Loading Dock

The arena loading dock consists of two loading bays, drive-in access, and vehicle parking spaces. Additional on-site parking available as needed for marshalling or staff.

Loading Bays: 2

Parking Spaces: 6

Shore Power Accessible

Drive-In Door: 12'W x 10'H



Exhibit Hall Loading Dock

The exhibit hall loading dock consists of six loading bays, drive-in access, and vehicle parking spaces. Additional on-site parking available as needed for marshalling or staff.

Loading Bays: 6

Parking Spaces: 8

Shore Power Accessible

Drive-In Door:
16'W x 20'H



DEAL STRUCTURE

Base Rental Per Day Includes:

- Facility Rental
- Front of House Staff
 - *Perimeter Security*
 - *Guest Services*
 - *Box Office Staffing*
 - *Crowd Managers*
 - *Ushers*
- Administrative Overhead
- Traffic Control
- Emergency Medical Services
- (1) Lighting and Sound Technician
- Dressing Rooms including towels and soft goods
- Housekeeping
- (6) Spotlights
- Stage electrical
- Staging up to 80'W x 40'D x 4'H

Requirements Above Base Rental

- Additional Staging
- Riggers
- Electrical Installations
- Spotlight Operators
- Post-Show Cleaning
- Catering
- Stagehands
- Magnetometers
- Event Security and/or Police
- ASCAP, BMI, SEASAC, etc.

Facility Assistance Upon Request

- Talent Buying (Music, Comedy, Speakers)
- Marketing/Advertising
- Hotel
- Runners
- Forklift and Boom lift



If you need assistance with something not listed, just ask!



Ocean Center

DAYTONA BEACH

OceanCenter.com

 [TheOceanCenter](#) |  [TheOceanCenter](#) |  [ocean-center](#)