



Ocean Center
DAYTONA BEACH

Go Beyond...

ENTERTAINMENT TECH PACK

TABLE OF CONTENTS

Arena	1-4
Exhibit Hall	5
Ballroom	6
General Information: Arena Loading Dock, Exhibit Hall Loading Dock	7
General Information: Dressing Rooms, Power and Electrical Services, Staging, House Inventory	8
Deal Structure	9



ARENA FLOORPLAN

The arena is a versatile and dynamic space designed to host a wide range of productions. It features flexible seating and stage configurations, ample rigging capabilities, high-quality sound and lighting systems, and convenient loading dock access.

Fast Facts

42,000 square feet

8,375 total seats

2,200 standing room

Stage Size: 60'W x 40'D x 4'H

Full House

- **Lower Seating:** 2,696
- **Upper Seating:** 3,891
(section 201 and 222 excluded)
- **Floor Seating:** 1,788

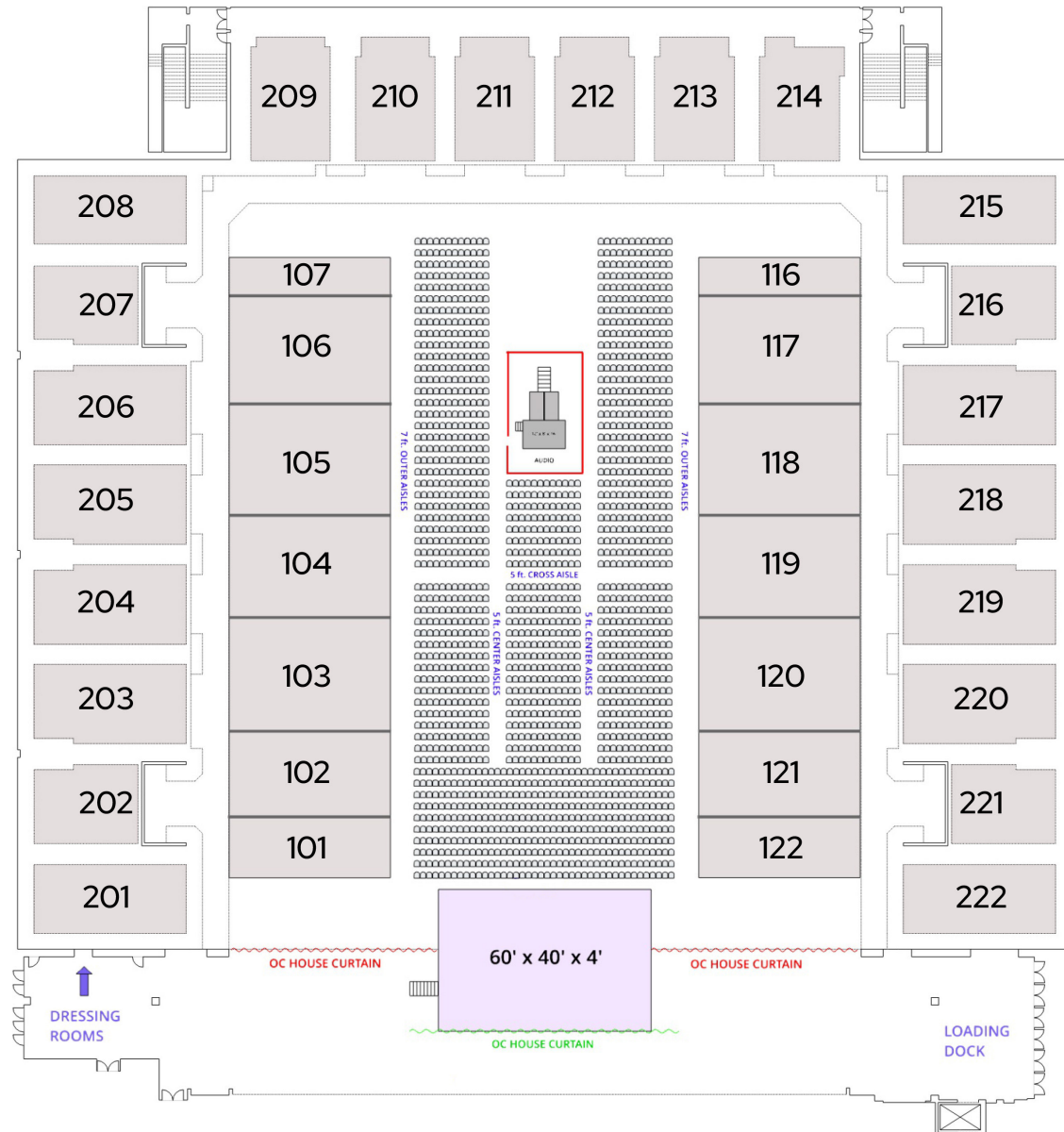

ARENA FLOORPLAN

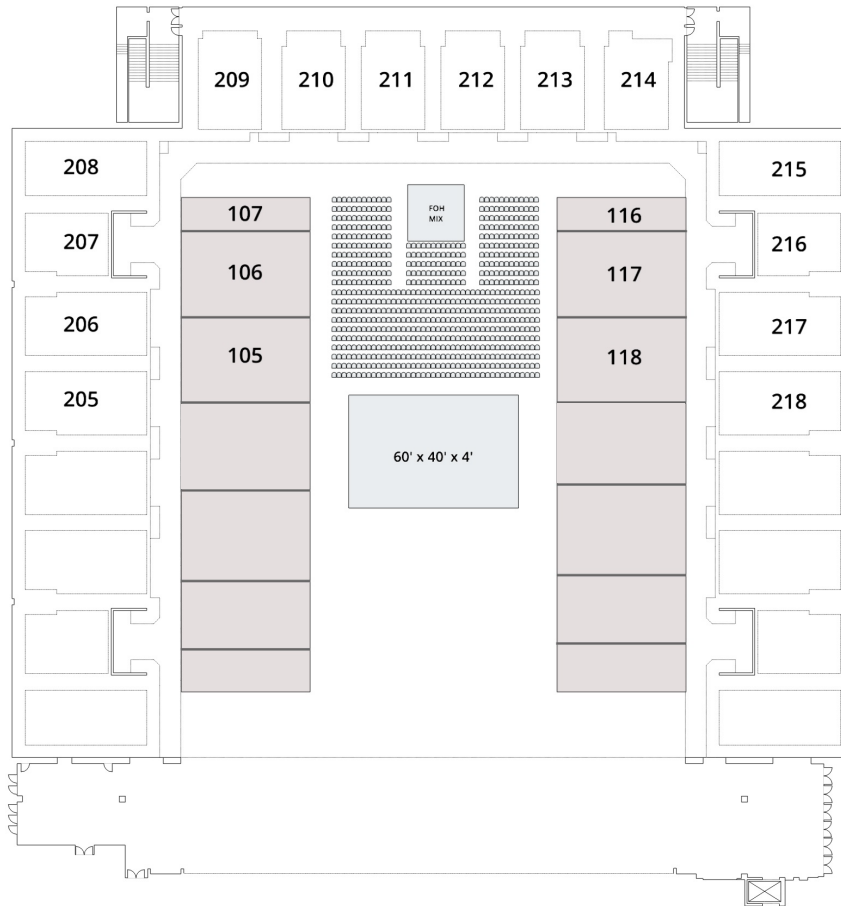

Half House

Fast Facts

- **Lower Seating:** 1,110
- **Upper Seating:** 2,685
- **Floor:** 720

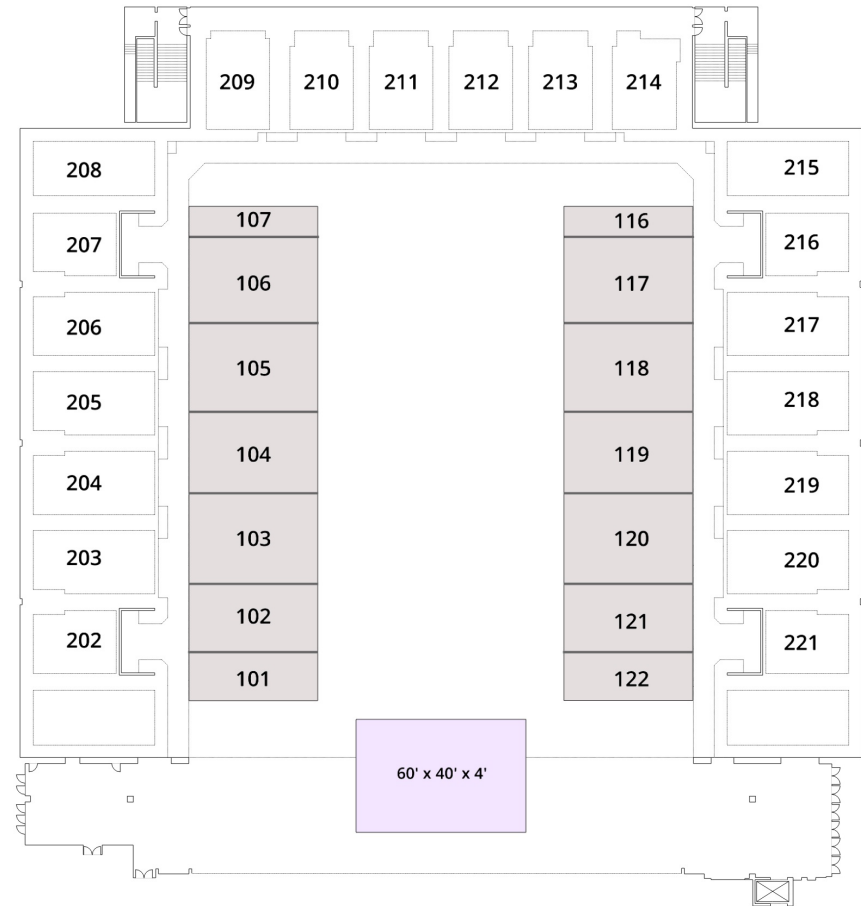

GA Seating

Fast Facts

- **Lower Seating:** 2,696
- **Upper Seating:** 3,891
- **Floor:** 1,788 optional or 2,200 standing

ARENA RIGGING

Low steel height from finished floor is 47'. | High steel height from finished floor is 72'.

Rigging point weight ratings:

4,000 lb: 32 points distributed across the arena steel structure (low steel).

8,000 lb: 3 points centered on the east end of the arena directly above staging (low steel).

The facility coordinates use of riggers, load crew, stagehands, camera operators and spotlight operators in instances where the show promoter or lessee does not have their own. If the traveling production team does not include rigging personnel, the Ocean Center will exclusively manage all rigging services to ensure safety and efficiency.

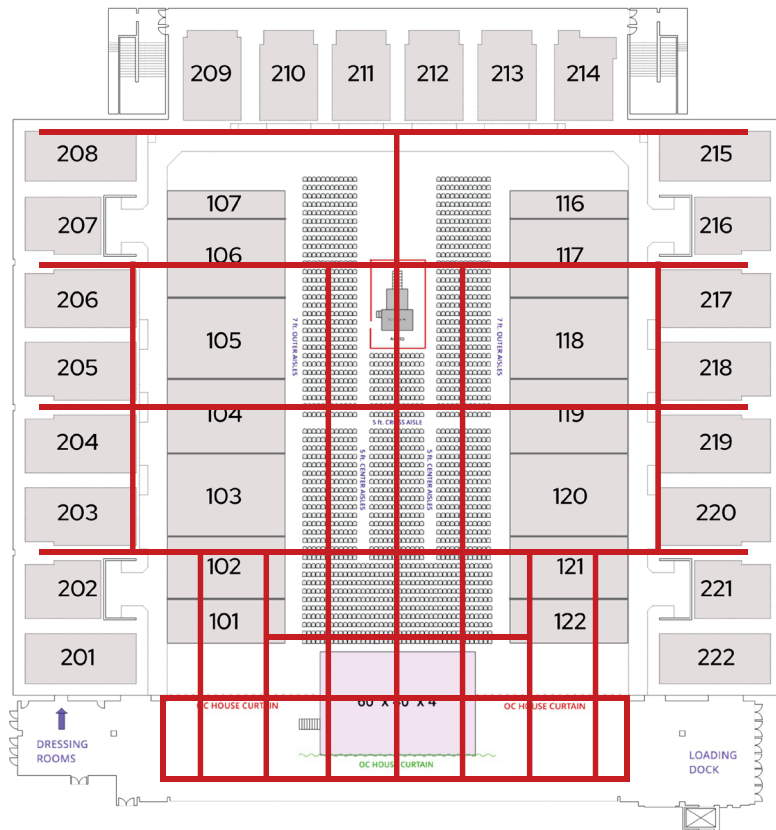

Fast Facts

Chain Motors:

- **Description:** ½ Ton Chain Motors
- **Quantity:** 10 units available
- **Use:** Suitable for lifting and rigging purposes

Truss Sections:

Rigging points:

1. 12"x12" Square Truss Sections:

- **Quantity:** 31 units available
- **Details:** 10' sections including 4 corner pieces

2. 12" Triangular Truss Sections:

- **Quantity:** 24 units available
- **Type:** Rhone Tower
- **Details:** Suitable for structural support and rigging

ARENA SYSTEMS

Sound

The sound system features new amplifiers and cabling, as well as touch panel controls.

Lighting

The new system features advanced LED technology for improved control options. Does not interface with DMX systems.

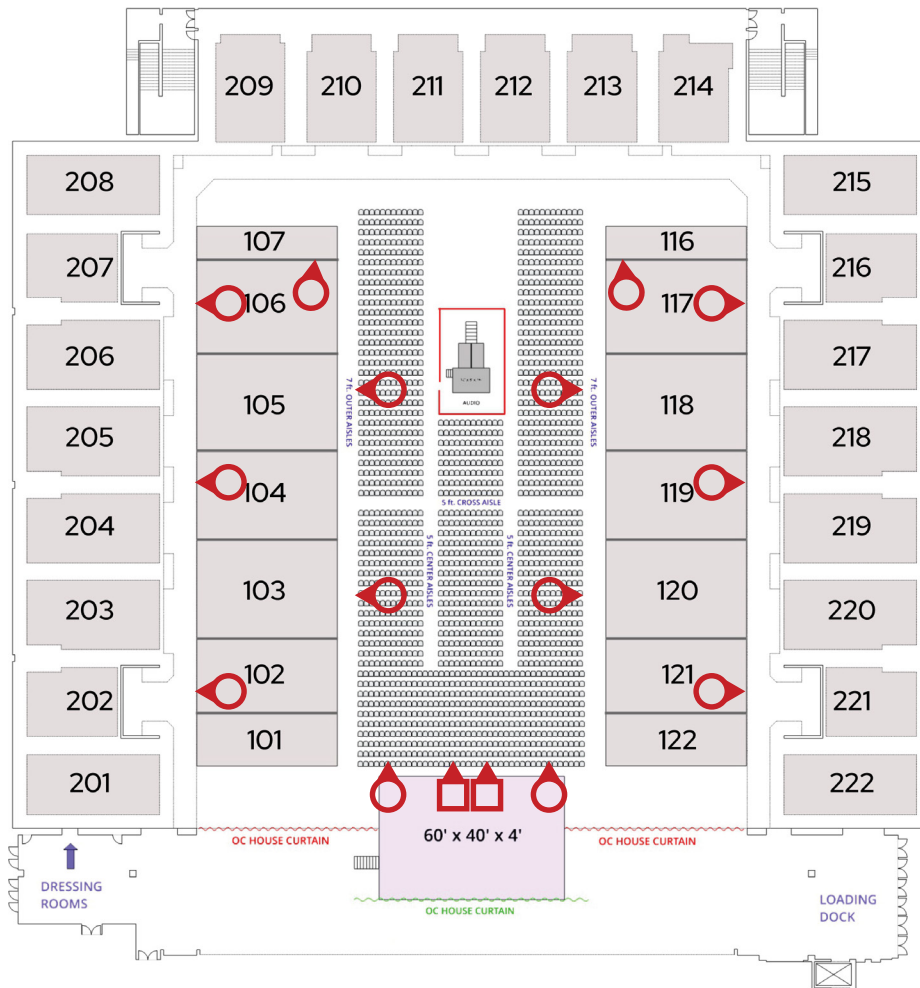

EXHIBIT HALL FLOOR PLAN

Exhibit Hall

The spacious and adaptable exhibit hall offers endless possibilities for productions of all sizes and styles. This open and flexible space is designed to host everything from music festivals, and creative productions like Electronic Dance Music (EDM) and everything in between.

Fast Facts

Ceiling Height: 32'
(with no rigging points)

Square feet: 93,000

Stage Size: 60'W x 40'D x 4'H

Standing Capacity: 9,000

Banquet Seating: 500

Theater Seating: 3,000

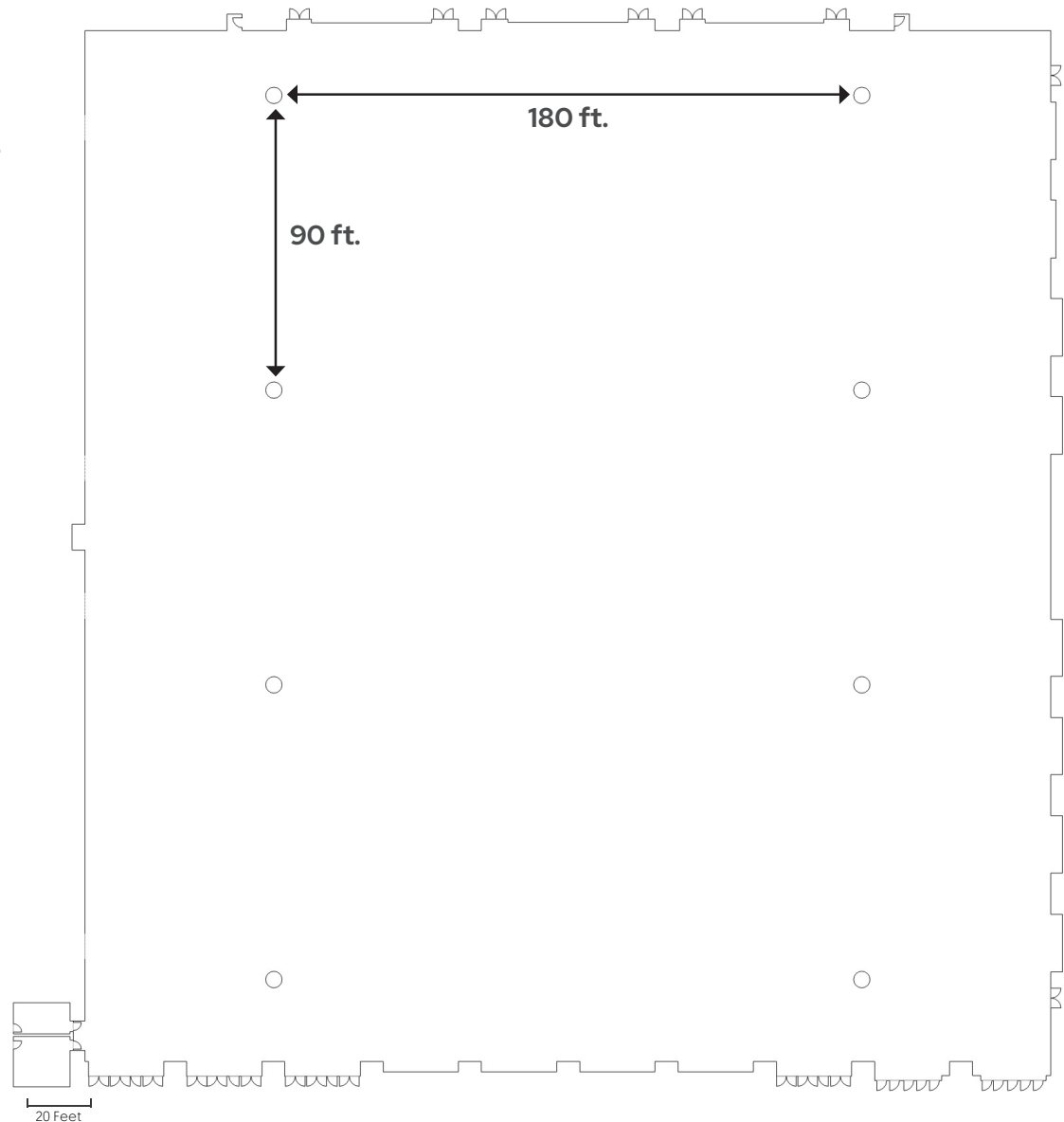

BALLROOM FLOOR PLAN

Ballroom

The ballroom offers an elegant and versatile setting for events and with over 12,000 square feet of customizable space, it's the ideal venue for intimate concerts.

Fast Facts

Seated: 1,000 | **Standing:** 1,600

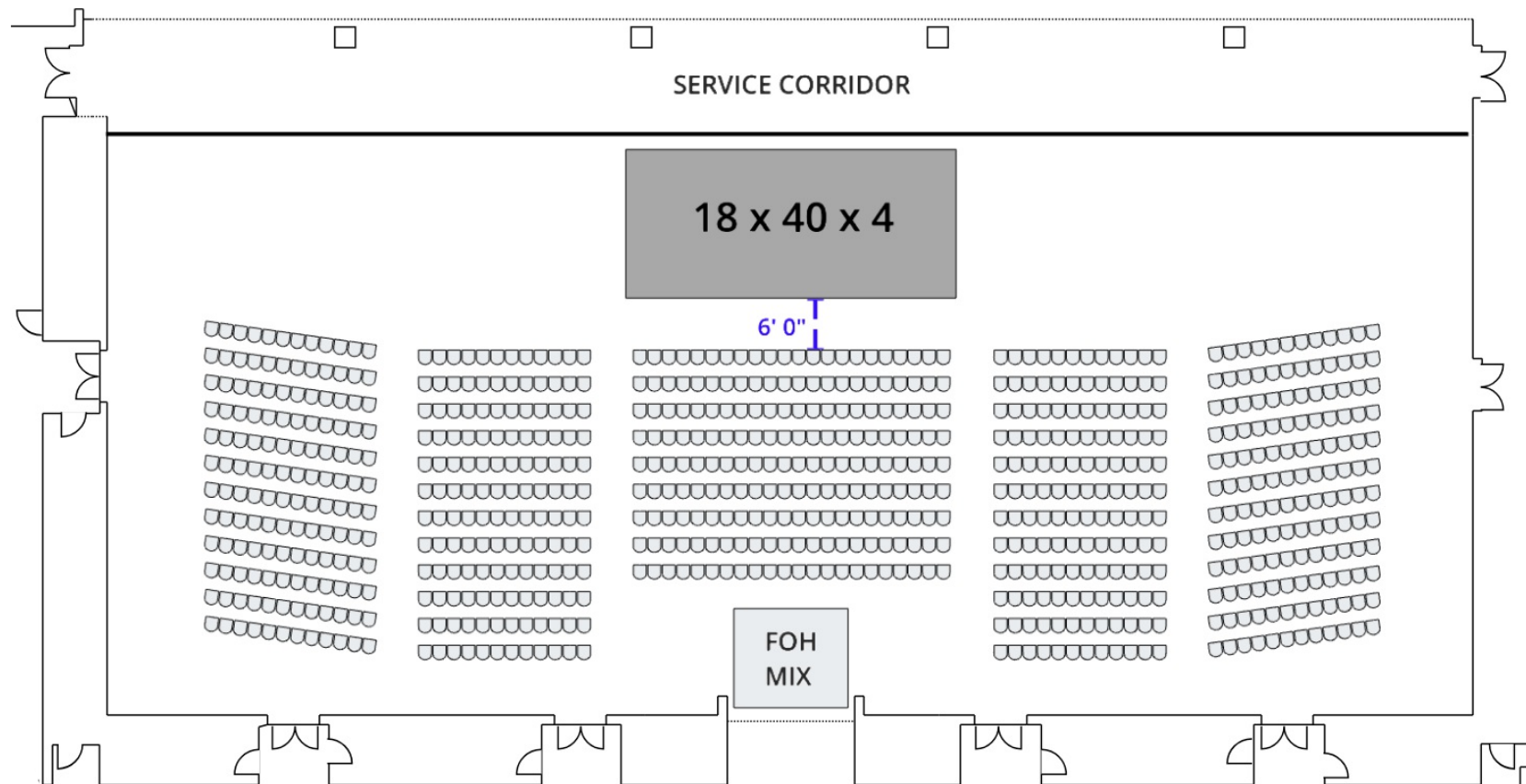

GENERAL INFORMATION

Arena Loading Dock

The arena loading dock consists of two loading bays, drive-in access, and vehicle parking spaces. Additional on-site parking available as needed for marshalling or staff.

Fast Facts

- 2 Loading Bays
- 6 Parking Spaces
- 12'W x 10'H Shore Power Accessible Drive-In Door



Exhibit Hall Loading Dock

The exhibit hall loading dock consists of six loading bays, drive-in access, and vehicle parking spaces. Additional on-site parking available as needed for marshalling or staff.

Fast Facts

- 6 Loading Bays | 8 Parking Spaces
- Shore Power Accessible
- 16'W x 20'H Drive-In Door



GENERAL INFORMATION

Dressing Rooms

Eight dressing rooms conveniently located approximately 100' from backstage left.

Fast Facts

- 8 Dressing Rooms
- Dressing Rooms A & B: No Showers or Restrooms
- Dressing Rooms C & D: 1 Shower, 1 Sink, 1 Stall
- Dressing Rooms E - H: 4 Showers, 3 Sinks, 2 Stalls, 2 Urinals

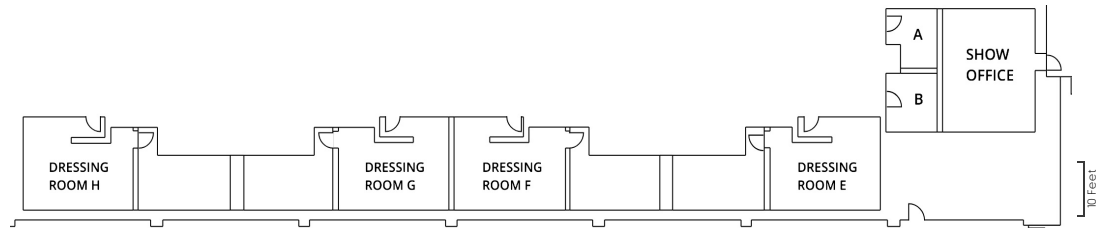

Power and Electrical Services

Stage power is included in rent. Additional power is available from floor boxes strategically located in the arena, exhibit hall and ballroom. Power is provided exclusively in-house.

Staging

The largest four (4) foot stage available is 80'W x 40'D x 4'H.

The largest two (2) foot stage available is 60'W x 40'D x 2'H.

House Inventory

A list of production related inventory available upon request.



DEAL STRUCTURE

Base Rental Per Day Includes:

- Facility Rental
- Front of House Staff
 - *Venue Safety and Security*
 - *Guest Services*
 - *Box Office Staffing*
 - *Crowd Managers*
 - *Ushers*
- Administrative Overhead
- Traffic Control
- Emergency Medical Services
- (1) Lighting and Sound Technician
- Dressing Rooms including towels and soft goods
- Housekeeping
- (6) Spotlights
- Stage electrical
- Staging up to 80'W x 40'D x 4'H

Requirements Above Base Rental

- Additional Staging
- Riggers
- Electrical Installations
- Spotlight Operators
- Post-Show Cleaning
- Catering
- Stagehands
- Magnetometers
- Event Security and/or Police
- ASCAP

Facility Assistance Upon Request

- Marketing/Advertising
- Hotel
- Runners
- Forklift and Boom lift



If you need assistance with something not listed, just ask!



Ocean Center

DAYTONA BEACH

Miguel Garcia De Quevedo | VENUE ENTERTAINMENT MANAGER

mgarciadequevedo@oceancenter.com | 386-254-4544 | OceanCenter.com

f TheOceanCenter | **@ TheOceanCenter** | **in ocean-center**